

PLAN VIEW

NTS

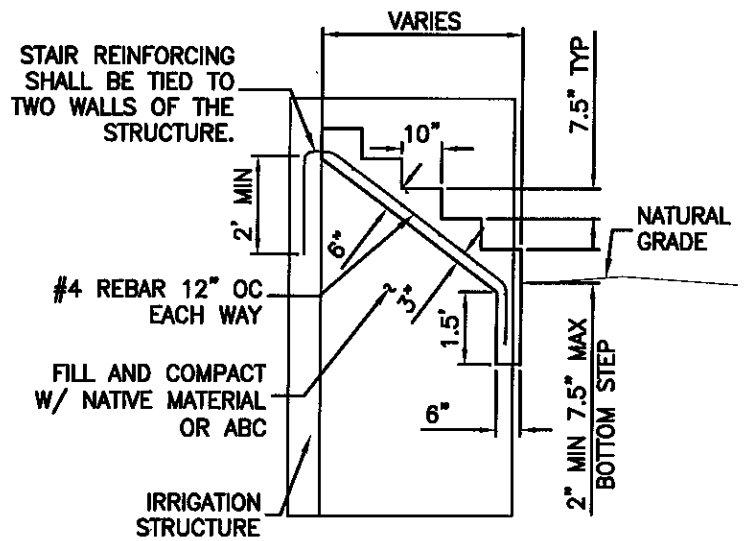

SECTION A-A

NTS

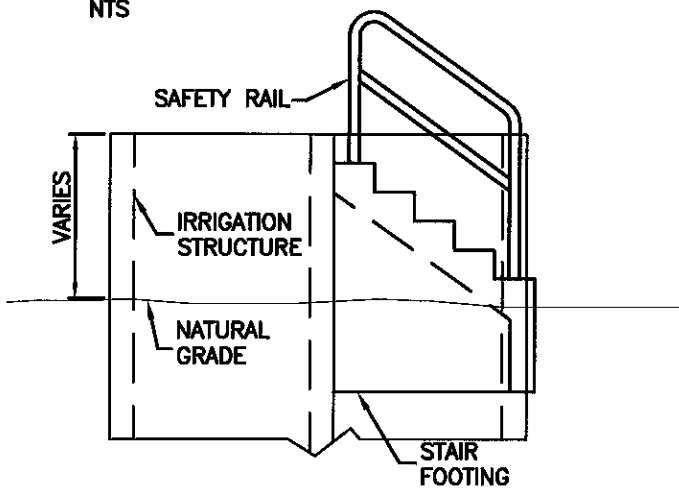

PROFILE VIEW

NTS

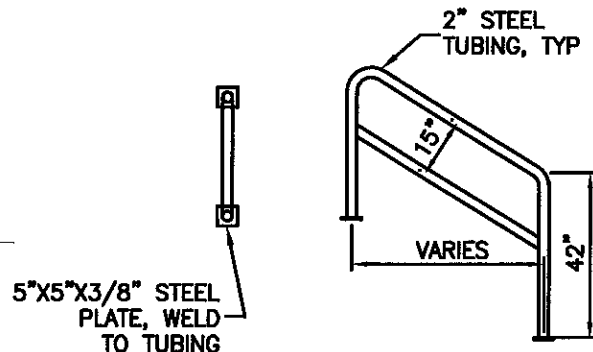

PLAN

PROFILE

SAFETY RAIL

NTS

NOTES:

1. ALL WELDED CONNECTIONS SHALL BE 3/8" FULL STRENGTH WELDS ALONG THE ENTIRE LENGTH OF CONNECTION AND MUST BE IN ACCORDANCE WITH AWS AND AISC CODES.
2. ALL METAL SURFACES AND WELDED CONNECTIONS SHALL BE PAINTED WITH ONE COAT ZINC CHROMATE OR RED LEAD PRIMER (INDUSTRIAL QUALITY). THE SECOND COAT SHALL BE GRAY INDUSTRIAL ENAMEL PER MAG SPEC 790.
3. ANCHOR PLATE TO CONCRETE STAIR WITH 4 EA. 1/4" DIA BOLTS EPOXIED 3" INTO CONCRETE OR WELD 1 EA. 1/2" DIA 6" HOOKED ANCHOR BOLT TO THE PLATE AND SET IN WET CONCRETE.
4. STAIR TO BE MIN 2500 PSI CONCRETE.
5. STAIR STEP SHALL HAVE 3/4" ROUNDED EDGE.

LAST UPDATED: 03/06/06

ROOSEVELT WATER CONSERVATION DISTRICT

CONCRETE STRUCTURE STAIRS